

# #proudtobeCampion



# Welcome Back!



CREATING  
BRILLIANT  
FUTURES



# September 2020

## Guidance and expectations for students and parents/carers



# Preparing for school



- Attendance is compulsory - it is vital you don't miss any more learning time
- You need to wear full school uniform
- Full uniform expectations can be found here:  
[http://www.campion.northants.sch.uk/uploads/asset\\_file/3\\_726\\_school-uniform-standards-sept-2020-v2.pdf](http://www.campion.northants.sch.uk/uploads/asset_file/3_726_school-uniform-standards-sept-2020-v2.pdf)
- You will need to bring in your own equipment each day
- You will be responsible for your exercise books which you will take home and bring back each day

## Equipment

- A pencil case
- 2 black pens
- 2 HB pencils
- 2 red pens
- Ruler
- Eraser
- Pencil sharpener
- Calculator
- A suitable bag
- Water bottle
- Face mask- if travelling by bus

\*there can be no sharing of equipment



# Getting to school



- School bus transportation will operate (Please see letter dated 20/8/20 for additional information)
- You are required to wear a face covering on school buses
- If you come on the D3 bus you will need to check bus times, and it is compulsory to wear a face covering on public transport
- We encourage you to walk or cycle where possible
- Staff will be on hand to direct you on entry to school
- We are unable to offer a breakfast service at this time
- When you arrive, you must go to your form room and nowhere else



# Bus travel



shutterstock.com • 1078162406

- You are expected to only sit with pupils from your year group (there will be signs on the buses)
- You should ensure your face covering is worn on the bus
- You should follow school conduct expectations whilst on the bus
- You must follow the bus driver's instructions whilst on the bus
- You should use hand sanitiser as you enter and leave the bus
- Face coverings should be disposed of or securely stored in a plastic bag once used



# The School Day- year group bubbles

- All students will be taught and have their break and lunch in year group bubbles
- Each year group have been allocated a zone within the school site
- Students will experience their full curriculum offer over a 4 week timetable
- The school have scheduled a staggered return to allow each year group to adjust to the new school systems

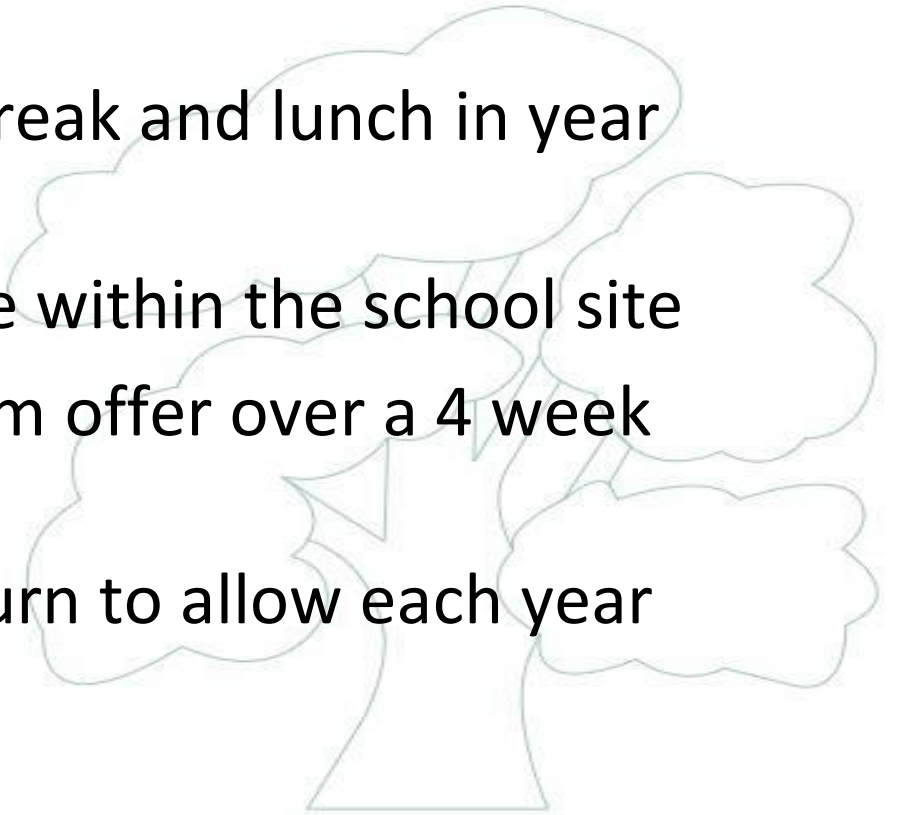

# Year Group Zones

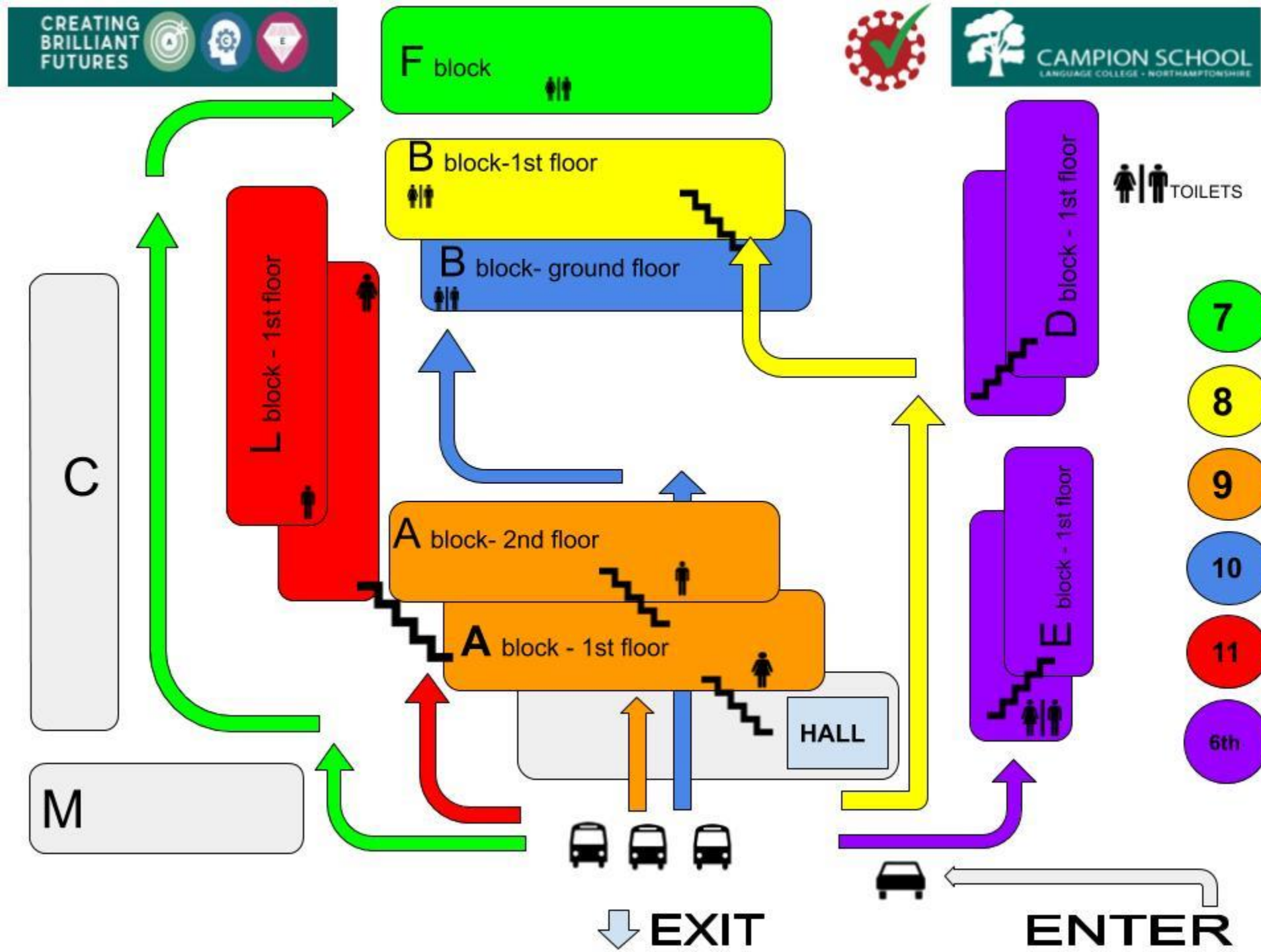

# Teaching and learning

- Your year team staff will meet you on your first day back and escort you to your year group zone.
- You will be given a timetable on your first morning so you are clear where your lessons are
- Your desks will face the front of the classroom
- Teachers will maintain social distance from pupils
- We will not have lockers available for use at this time
- Teachers will be unable to loan you any equipment
- Current government guidance states face coverings for staff and students are not to be worn in school





# Timetable

- You will experience all of your usual lessons including PE, over a 4-week cycle
- The timetable has changed from five to three sessions per day to reduce movement.

Time	Period
8.45- 9.00	Tutor time in year group zones
5 minute movement time for staff	
9.05 – 11.30	Period 1 – 2 hours Break – 25 minutes (3 staggered breaks)
11.30-2.05	Period 2 – 2 hours Lunch – 30 minutes (3 staggered lunches)
2.05- 3.05	Period 3 – 1 hour



# At the start of each lesson:

- All students will be expected to line up outside the classroom at the start of each lesson, this allows time for staff to move between lessons.
- Students will be supervised whilst lining up outside classrooms in their allocated zones.

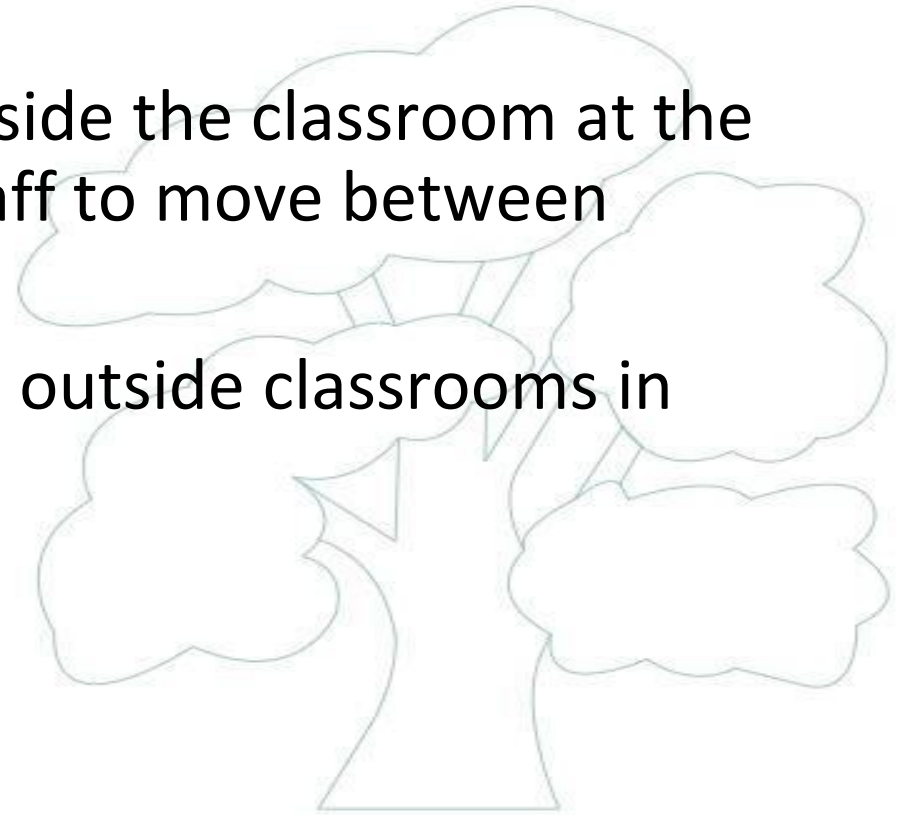

# PE

- All students will experience a practical PE lesson per cycle
- Students will need to come to school in their school PE kit on the days they have PE as we will not have facilities for changing on site
- Students are advised to wear their winter school PE kits; school rugby top and plain black jogging bottoms.



## Break and lunchtime

- You will remain in your year group bubble for break and lunchtime
- Break and lunch times will be staggered to ensure each group can use the facilities
- Hot and cold food will be available and if you get a free school meal this will continue
- You can only pay using the cashless system
- You will have access to a designated outdoor space
- Wet weather arrangements will also be in place.



# Preventative measures

- You should stay at home if you are ill
- If you experience symptoms of corona virus a test should be booked
- You must wash your hands regularly and make use of hand sanitising stations
- If you need to cough or sneeze then use a tissue or your sleeve (catch it/kill it/bin it)
- **You should have no physical contact with other students**
- If you do not follow the expectations, sanctions will be applied
- The principle of Warn/Move/Remove will continue
- Revised Covid-19 Behaviour Policy Annex can be found on the school website



## At the end of the school day

- School finishes for all students at the normal time of 1505
- We are currently not offering an enrichment programme
- You will follow your designated route to reach the buses or exit gate
- You will move directly to your bus and sit in year groups
- If you travel on a late bus you will be directed to a year group area to wait with your year group
- If being collected by car your parent will be asked to arrive after 1520 to allow time for the buses to leave

